



Hindu Center of Virginia New Traditional Temple Expansion Plans



++++
"Offer in thy heart all thy works to me, and see me as the End
of thy love, take refuge in the Yoga of reason, and ever rest in
thy soul in me."

—Bhagawad Gita Chapter 18 vs. 57

++++

6051 Springfield Drive, Glen Allen, VA 23060
Tel# 804-346-9954
<http://www.hinducenterofvirginia.org>

Coming Soon:
www.TheRichmondTemple.org

TEMPLE EXPANSION COMMITTEE MEMBERS

Please contact the following members of the expansion and fund raising committee to indicate your level of commitment in making our dream of building the temple a reality!

Chair Person

Chandrashekhar Challa

Tel # 804-364-2492

email: shekarchalla@aol.com

Co-Chair Person

Manikoth Kurup

Tel # 804-457-2194

email: rajakaju@hotmail.com

Co-Chair Person

Gopinath Jadhav

Tel # 804-754-2138

email: gijadhav@aol.com

Co-Chair Person

Inder Midha

Tel # 804-739-1246

email: imidha@comcast.com

MEMBERS:

Nilkanth Bhatt

Tel # 804-364-1396

email: nbhatt@nbjarch.com

Surya Dhakar

Tel # 804-747-1025

email: dhakar@gmail.com

Anil Jain

Tel # 804-360-1760

email: jainanilk@aol.com

Ram Ramachandran

Tel # 804-530-5274

email: rameena2@yahoo.com

Jagan Reddy

Tel # 804-530-4686

email: jaganreddy37@yahoo.com

T. K. Somanath

Tel # 804-744-3148

email: tsomanath@aol.com

Ram Gupta

Tel # 804-781-1696

email : ra4gupta@yahoo.com

Rambabu Chirumamilla

Tel # 804-530-1565

email: doctorvijaya@hotmail.com

Anup Gokli

Tel # 804-754-1445

email: gokli@aol.com

Veena Kukreja

Tel # 804-794-1594

email: dvkukreja@comcast.net

Ravindra P.V.

Tel # 804-527-8373

email: pvravindra@yahoo.com

Ranjit Sen

Tel # 804-282-3479

email: ranjitsen@codexinc.com

Navin Tejani

Tel # 804-739-1447

email: navintejani@aol.com

AN APPEAL FOR YOUR DONATIONS AND SUPPORT FOR THE TEMPLE EXPANSION

Human life is a rare gift. It is a gift from the Lord. Everyone must know the Divine is within Him. God is within you and you are in Him. Attainment of God is the supreme purpose of life. In order to progress in this Spiritual path one should know the fundamentals of spiritual life. Our vision for the Hindu Center is to serve the purpose of giving some practical and useful information in this direction. Hindu Center's goal is to make a sincere effort to serve earnest seekers after spiritual truth and to spread spiritual wisdom that is likely to benefit mankind.

Since the Center was established more than 25 years ago, we have experienced a tremendous growth of families attending the Center's activities. The current multipurpose hall which serves as an altar, dining room, concert hall, and classrooms is less than adequate. During the past year, the devotees of the Center have determined that expansion of the Center consistent with the proposed master plan to meet our current day needs of worship, religious education, and cultural programs is an immediate necessity.

The initial phase of the site preparation including the construction of parking lot for 224 cars was completed in September 2005. Next, establishing an authentic Temple and associated educational and cultural facilities is important in Hindu worship. The temple is a place where the God's presence is felt easily in a devotee's heart, a place where they make themselves visible and accessible to the devotees.

The expansion plan's capital cost is estimated to be four million dollars and our goal is to raise these funds to start the construction and establish a traditional Temple and expansion of other related facilities.

We need your help and support at this crucial juncture of the Center. Your participation will bring you and your family the 'punya' that we all are seeking as humans. Hindu philosophy advocates active participation in the construction of a temple is one of the many ways to attain 'punya' in 'kalyuga'. Such participation of devotees is essential not only for the growth of our beloved institution but also to enable our children to continue to reap the benefits of our values, customs and traditions for years to come. We hope that you all will make this 'dream project' a reality by donating 'from your heart' by 'digging deep into your pockets' and 'be generous'. When completed, this will be the only authentic Temple in Central Virginia that will meet the religious needs of the Hindu and Jain families.

*Board of Trustees
Expansion \$ Fund Raising Committee
Executive Committee*

HISTORY OF HINDU CENTER OF VIRGINIA

1976:

ORIGINAL NAME OF ORGANIZATION:

- "RELIGIOUS & CULTURAL CENTER OF INDIA"

FIRST FUND RAISER:

- RAVI SHANKAR CONCERT AT THE MOSQUE THEATER

1982:

NEW NAME FOR THE ORGANIZATION FOUNDED

- THE HINDU CENTER OF VIRGINIA
- CELEBRATION OF GANESH CHATURTHY

FIRST "INDIA BAZAAR"

- AT JOHN B CAREY ELEMENTARY SCHOOL

1983:

FIFTEEN ACRES OF LAND PURCHASED

1986:

GROUND BREAKING OF THE HINDU CENTER OF VIRGINIA

1988:

HINDU CENTER OF VIRGINIA BUILDING COMPLETED

- DEDICATED BY HONORABLE GOVERNOR G. BALILES

1989:

SEVEN DEITIES INSTALLED

1993:

1st ADDITIONAL LOT OF 6 ACRES PURCHASED

1999:

2nd ADDITIONAL LOT OF 4 ACRES PURCHASED

2005:

**PARKING LOT AND SITE PREPARATION FOR THE CONSTRUCTION OF
TRADITIONAL TEMPLE COMPLETED**

2007:

CONSTRUCTION OF TRADITIONAL TEMPLE TO COMMENCE

DETAILS OF SITE PREPARATION & PARKING LOT PHASE

■ **This phase included the following activities
(completed in September 2005)**

Site Preparation and Engineering for construction of traditional temple
Water Connection from County Line:
Soil Erosion and Land leveling 224 Parking Spaces

■ **Cost for this phase:**

Engineering	\$30,688.54
Professional Fees	\$25,238.49
Virginia Power	\$15,701.00
Landscape & Irrigation	\$36,257.00
Electrical (Parking Lot)	\$55,817.00
Blakemore Construction	<u>\$711,548.00</u>
Total	\$875,250.03

COST DETAILS OF TRADITIONAL TEMPLE PHASE

■ **Approximate Cost \$4 million (To Commence in 2007)**

Traditional New Temple & Educational Wing	\$2.1 million
Indianization & Gopuram (Main Entrance)	\$1.0 million
Dinning Hall, and Kitchen	\$0.9 million

DETAILS OF THE FINAL PHASE

■ **Activities include the following:**

Retirement Homes
Priest Home
Recreational Facilities
Renovation of Existing Hall (Auditorium) & Additional Parking Spaces

TIME LINE FOR NEW TEMPLE CONSTRUCTION PHASE

A. 2006

Accomplishments

1. Received approval from Henrico County
2. Expecting to raise at least \$1 million by December 2006
3. Enhanced website
4. Interviewed financial Institutions

B. 2007

- Send bids for construction & interview contractors
- Finalize loan & construction documents & award contract
- Ground breaking of the traditional temple

FREQUENTLY ASKED QUESTIONS

1. What is the total cost of the temple construction phase?
 - As of now anticipated cost is \$4 million.
2. Is it possible to donate on the web?
 - Yes. Visit the temple web site at:
<http://www.hinducenterofvirginia.org> and click on
“Center Expansion” and follow the link to “Donations”.
3. Can we donate with credit card?
 - Yes. You can visit the temple web site and provide the credit card details. Your information will be securely transmitted and stored on a secure server. Alternatively, you may call Mrs. Veena Kukreja at 804-794-1594 or send her the details to 12004 Bromwich Ct, Richmond, VA 23236.
4. Do we have direct debit facility?
 - Yes. Please visit the temple web site to know more about this facility and to download the direct debit form.
5. What will be the size of the new temple?
 - The Size will be about 8500 square foot.
6. What will be the capacity of the new temple?
 - The capacity will be approximately 820 people as against the current capacity of about 400.
7. Can we afford to finance this expansion project?
 - Twenty-five years ago the same question was asked and the community of only 125 families got together and built the present building. With the help of more than 3000 families now, we are absolutely sure we can achieve our dreams again of building a traditional temple.

BUILDING I:

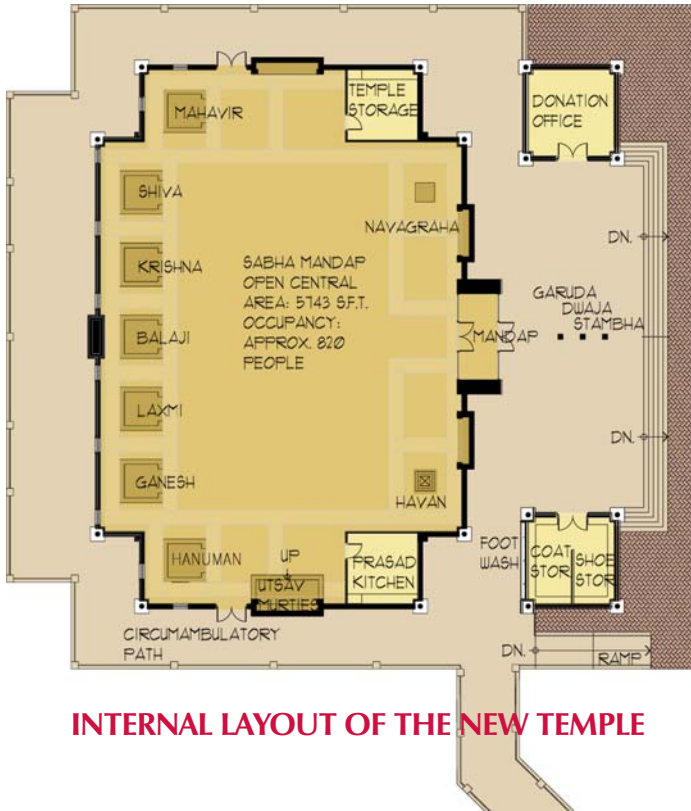

INTERNAL LAYOUT OF THE NEW TEMPLE

BUILDING II:

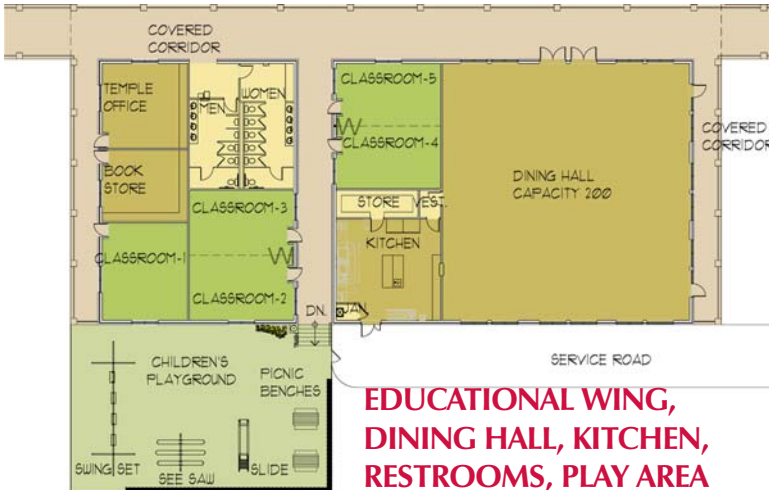

**EDUCATIONAL WING,
DINING HALL, KITCHEN,
RESTROOMS, PLAY AREA**

HINDU CENTER OF VA EXPANSION SITE PLAN:

